



PTWPA-2G8G-2000

2000W Pulse TWT Amplifier

Traveler Wave Tube (TWT) Power RF Amplifier

The PTWPA-2G8G-2000 is a TWT 2000W (Pulse) Ruggedized RF Amplifier which covers frequency range from 2GHz to 8GHz. This amplifier can achieve high efficiency operation with proven reliability as is designed with the robust engineering and employment of the most advanced devices and components. The amplifier comes with 2 years warranty including the TWT.

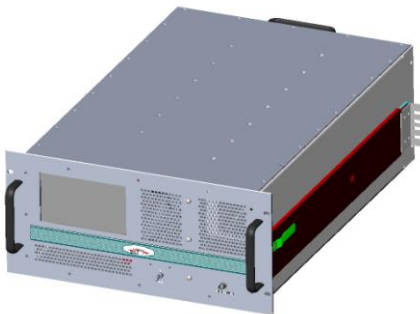

Parameter	Specification
Electrical	
Frequency Range	2-8GHz
Output Power	2000W Peak min, 2500W peak Typical
Internal Protection	Up to 0dBm for no damage
Gain @ rated power	63dB
Input /Output Impedance	50 ohms(VSWR 2.0:1)
Harmonics	2-4GHz, -1dBc 4-8GHz, -10dBc
Spurious	-50dBc max
Pulse Input	TTL. High=Beam-ON, Low=Beam-OFF BNC Female on Rear Panel
Pulse Width	150nSec-100uSec
Rise/Fall time	20nSec
Pulse Delay	60nSec
PRF	150KHz max.
Duty Cycle	0-6%
Pulse to Pulse jitter	±10nsec max.
Pulse Width jitter	±10nsec max.
Pulse to Pulse	±0.3dB max.
Stability	
Pulse Droop	0.2dB @ 10uSec pulse max. 0.5dB @ 100uSec pulse max.
RF Input/Sample Connectors	Type N Female On Rear Panel
RF Output Connector	Type 7/16 Female On Rear Panel

THESE SPECIFICATIONS ARE SUBJECT TO CHANGE WITHOUT NOTICE.



Parameter	Specification
Modulation	AM / FM / Pulse
Noise Power density	-8dBm/MHz, max.
Prime Power	220V AC +/-10%, 50/60 Hz, Three Phase 5 wires on the Rear Panel
Consumptions	2.0KVA max.
<u>Mechanical</u>	
Configuration	Racks mounts 19"W x 26.13"D x 8.75"H
Weight	100 lbs max.
Cooling System	Air cooled ,self contained
Shock	MIL-STD-810C, method 516.2, Procedure I, 15G. 11 ms 1/2 sine 3 axis 6 directions
Vibration	MIL-STD-810C, method 514.2, procedure VIII, curves V, 1.5G, 1 hr/axis, 3 axis, 5-5.5Hz 1 inch, 30Hz 0.033 inch
EMI	RE02 Requirements (Radiated emissions, Electrical field, 14KHz-10GHz) CE03 Requirements (Conducted emissions, power & interconnect leads, 0.015-50MHz)
Test Certificate	Included with shipment in the operation/maintenance manual
<u>Environmental</u>	
Temperature	0° to 50° C
Non-operating Temp	-20° to 70°C
Humidity	95% without condensation
Altitude	15,000 feet

THESE SPECIFICATIONS ARE SUBJECT TO CHANGE WITHOUT NOTICE.



OPTIONS

001	VSWR Protection against output mismatch
002	Alternate Prime Power (specify at time of order).
003	RS 232 & Ethernet Remote Control.
004	Forward RF Sample Port Type N Female -50dBc nominal on the Front or Rear Panel.
005	Reflected RF Sample Port Type N Female -50dBc nominal on the Front or Rear Panel.
006	RF Input / Output Connectors on the Front Panel (Specify front or rear at time of order).
007	Internal Systems Diagnostics.
008	Heater/Beam Elapsed Time Metering in hours.
009	RF Safety Interlock, type BNC Connector.
010	Slides for Rack mount.

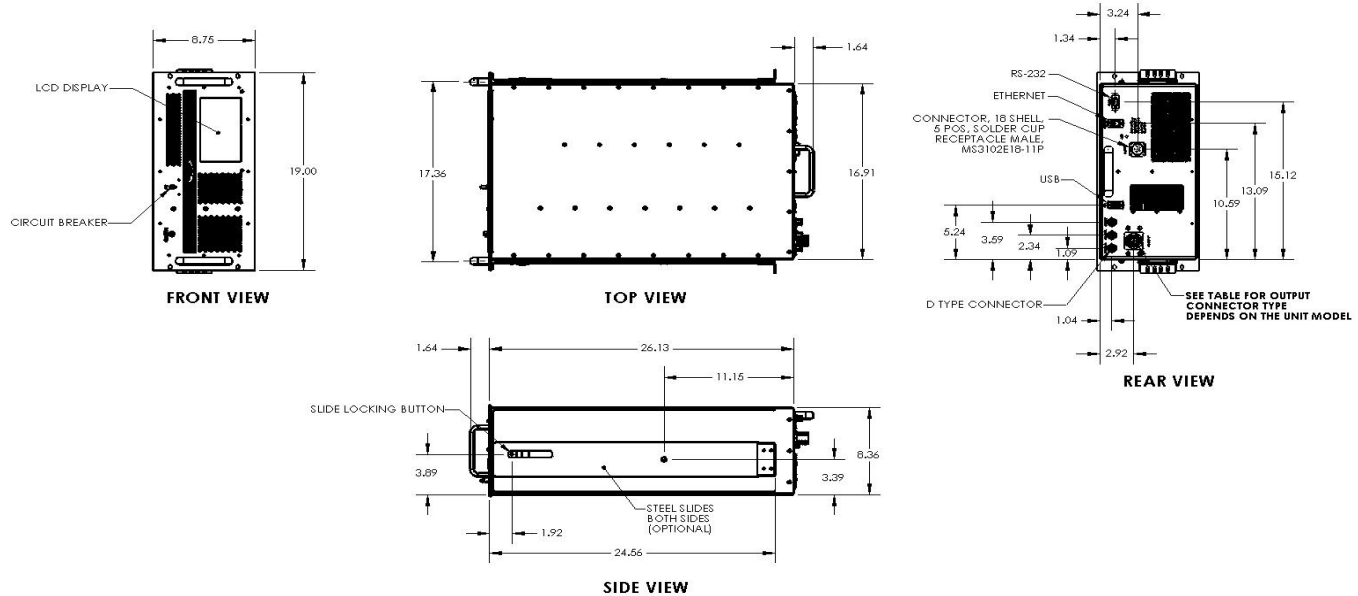

PowerMax Innovation, Inc.
 1243 Reamwood Ave., Sunnyvale,
 CA 94089 USA
 Tel.: (408) 541-0888
 Fax.: (408) 541-1886
 E-Mail: sales@pmaxii.com
 Web: www.pmaxii.com

THESE SPECIFICATIONS ARE SUBJECT TO CHANGE WITHOUT NOTICE.